

# ITCM



Available in configuration with three or four mounting assemblies.

## LOAD CELL CERTIFICATIONS



## SPECIFICATIONS

<b>**LOAD RATING/DIMENSIONS</b>				
<b>LOAD CELL CAPACITY</b>	<b>A</b>	<b>B</b>	<b>C</b>	<b>D</b>
<b>Inches (mm)</b>				
100lb (45.4kg)	2.00 (50.8)	1.81 (46.0)	3/8-16 NC	7.00 (ref) (177.8)
100lb (45.4kg)	2.00 (50.8)	1.81 (46.0)	1/2-13 NC	7.00 (ref) (177.8)
150lb (68.0kg)	2.00 (50.8)	1.81 (46.0)	3/8-16 NC	7.00 (ref) (177.8)
150lb (68.0kg)	2.00 (50.8)	1.81 (46.0)	1/2-13 NC	7.00 (ref) (177.8)
200lb (90.7kg)	2.00 (50.8)	1.81 (46.0)	3/8-16 NC	7.00 (ref) (177.8)
200lb (90.7kg)	2.00 (50.8)	1.81 (46.0)	1/2-13 NC	7.00 (ref) (177.8)
250lb (113.4kg)	2.00 (50.8)	1.81 (46.0)	3/8-16 NC	7.00 (ref) (177.8)
250lb (113.4kg)	2.00 (50.8)	1.81 (46.0)	1/2-13 NC	7.00 (ref) (177.8)
500lb (226.8kg)	2.68 (68.1)	2.68 (68.1)	1/2-13 NC	9.50 (ref) (241.3)
500lb (226.8kg)	2.68 (68.1)	2.68 (68.1)	5/8-11 NC	9.50 (ref) (241.3)
500lb (226.8kg)	2.68 (68.1)	2.68 (68.1)	3/4-10 NC	9.50 (ref) (241.3)
750lb (340.2kg)	2.68 (68.1)	2.68 (68.1)	1/2-13 NC	9.50 (ref) (241.3)
750lb (340.2kg)	2.68 (68.1)	2.68 (68.1)	5/8-11 NC	9.50 (ref) (241.3)
750lb (340.2kg)	2.68 (68.1)	2.68 (68.1)	3/4-10 NC	9.50 (ref) (241.3)
1000lb (453.6kg)	2.68 (68.1)	2.68 (68.1)	1/2-13 NC	9.50 (ref) (241.3)
1000lb (453.6kg)	2.68 (68.1)	2.68 (68.1)	5/8-11 NC	9.50 (ref) (241.3)
1000lb (453.6kg)	2.68 (68.1)	2.68 (68.1)	3/4-10 NC	9.50 (ref) (241.3)
1500lb (680.4kg)	2.68 (68.1)	2.68 (68.1)	1/2-13 NC	9.50 (ref) (241.3)
1500lb (680.4kg)	2.68 (68.1)	2.68 (68.1)	5/8-11 NC	9.50 (ref) (241.3)
1500lb (680.4kg)	2.68 (68.1)	2.68 (68.1)	3/4-10 NC	9.50 (ref) (241.3)
2000lb (907.2kg)	2.68 (68.1)	2.68 (68.1)	1/2-13 NC	9.50 (ref) (241.3)
2000lb (907.2kg)	2.68 (68.1)	2.68 (68.1)	5/8-11 NC	9.50 (ref) (241.3)
2000lb (907.2kg)	2.68 (68.1)	2.68 (68.1)	3/4-10 NC	9.50 (ref) (241.3)
2500lb (1134.0kg)	2.68 (68.1)	2.68 (68.1)	5/8-11 NC	9.50 (ref) (241.3)
2500lb (1134.0kg)	2.68 (68.1)	2.68 (68.1)	3/4-10 NC	9.50 (ref) (241.3)
3000lb (1360.8kg)	3.37 (85.6)	3.37 (85.6)	3/4-10 NC	10.50 (ref) (266.7)
5000lb (2268.0kg)	3.37 (85.6)	3.37 (85.6)	3/4-10 NC	12.25 (ref) (311.2)
5000lb (2268.0kg)	3.37 (85.6)	3.37 (85.6)	1-8 NC	12.25 (ref) (311.2)
10,000lb (4535.9kg)	3.37 (85.6)	3.37 (85.6)	1-8 NC	12.25 (ref) (311.2)
15,000lb (6803.9kg)	4.00 (101.6)	4.12 (104.6)	1 1/4-7 NC	18.00 (ref) (457.2)
20,000lb (9071.9kg)	5.00 (127.0)	4.12 (104.6)	1 1/2-6 UNC	20.00 (ref) (508.0)

\*\* Load Rating is per module

## STANDARD FEATURES

- Capacities (per module): 100-20,000lb (45.4-9071.1 kg)
- Clevis mounts with nylon insulating washers
- Teflon®-lined rod end ball joints
- Load cell is completely isolated from stray currents\*
- Grounding strap provides alternative path to ground
- Complete package for ease of installation
- Provides correct load cell loading even in difficult installations
- Lower overall height compared to other isolated tension assemblies

### Complete Kit Includes:

- 1 JB4SS NEMA 4X stainless steel signal-trim junction box
- 3 or 4 ITCM assemblies with RL20000 NTEP Certified S-Beam load cells
- 25ft of Hostile Environment EL147HE SURVIVOR® load cell cable

\* Excluding 20,000lb (9071.9kg) capacity

Teflon is a registered trademark of E.I. DuPont

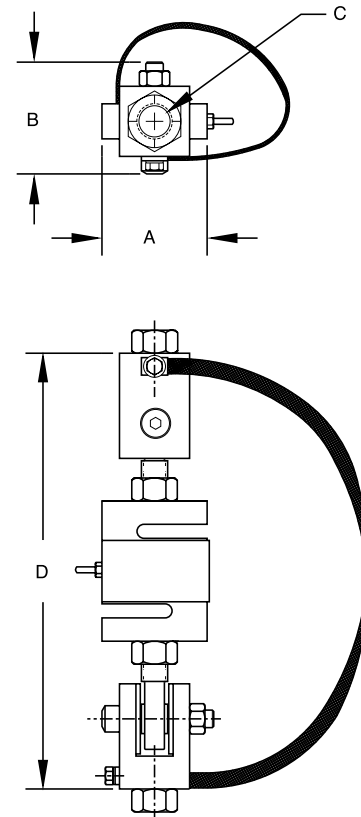

**LOAD RATING\* (LOAD CELL CAPACITY)**

	Single Module	3-Module Kit	4-Module Kit
	PART #	PART #	PART #
100lb (45.4kg) .....	17851.....	18003 .....	18027.....
100lb (45.4kg) .....	17831.....	18004 .....	18028.....
150lb (68.0kg) .....	30337.....	30357 .....	30359.....
150lb (68.0kg) .....	30336.....	30358 .....	30360.....
200lb (90.7kg) .....	30335.....	30361 .....	30363.....
200lb (90.7kg) .....	30338.....	30362 .....	30364.....
250lb (113.4kg) .....	17852.....	18005 .....	18029.....
250lb (113.4kg) .....	17832.....	18006 .....	18030.....
500lb (226.8kg) .....	17853.....	18007 .....	18031.....
500lb (226.8kg) .....	17858.....	18008 .....	18032.....
500lb (226.8kg) .....	17833.....	18009 .....	18033.....
750lb (340.2kg) .....	17854.....	18010 .....	18034.....
750lb (340.2kg) .....	17859.....	18011 .....	18035.....
750lb (340.2kg) .....	17834.....	18012 .....	18036.....
1000lb (453.6kg) .....	17855.....	18013 .....	18037.....
1000lb (453.6kg) .....	17860.....	18014 .....	18038.....
1000lb (453.6kg) .....	17835.....	18015 .....	18039.....
1500lb (680.4kg) .....	17856.....	18016 .....	18040.....
1500lb (680.4kg) .....	17861.....	18017 .....	18041.....
1500lb (680.4kg) .....	17836.....	18018 .....	18042.....
2000lb (907.2kg) .....	17857.....	18019 .....	18043.....
2000lb (907.2kg) .....	17862.....	18020 .....	18044.....
2000lb (907.2kg) .....	17837.....	18021 .....	18045.....
2500lb (1134.0kg) .....	17863.....	18022 .....	18046.....
2500lb (1134.0kg) .....	17838.....	18023 .....	18047.....
3000lb (1360.8kg) .....	30339.....	30365 .....	30366.....
5000lb (2268.0kg) .....	17864.....	18024 .....	18048.....
5000lb (2268.0kg) .....	17839.....	18025 .....	18049.....
10,000lb (4535.9kg) .....	17840.....	18026 .....	18050.....
15,000lb (6803.9kg) .....	17960.....	30353 .....	30354.....
20,000lb (9071.9kg) .....	17961.....	30355 .....	30356.....

\* Load rating is per module

Single models also available, consult factory for pricing.

**C&M Scale**  
**7241 W. Roosevelt Rd**  
**Forest Park IL 60130**  
**Sales, Service & Rentals**

**Toll Free: (800) 243-3721**  
**Phone: (708) 771-0100**  
**Fax: (708) 771-0196**  
**www.cmscale.com**