

ITCM HE



Available in configuration with three or four mounting assemblies.

STANDARD FEATURES

- Capacities (per module)**: 500-5,000lb (226.8-2268.0kg)
- Clevis mounts with nylon insulating washers
- Teflon®-lined rod end ball joints
- Load cell is completely isolated from stray currents
- Grounding strap provides alternative path to ground
- Complete package for ease of installation
- Provides correct load-cell loading even in difficult installations
- Lower overall height compared to other isolated tension assemblies

Complete Kit Includes:

- 1 JB4SS NEMA 4X stainless steel signal-trim junction box
- 3 or 4 ITCM assemblies with RL20001HE** stainless steel, welded seal NTEP Certified S-Beam load cells
- 25ft of Hostile Environment EL147HE SURVIVOR® load cell cable

Teflon is a registered trademark of E.I. DuPont

LOAD CELL CERTIFICATIONS



SPECIFICATIONS

**LOAD RATING/DIMENSIONS				
LOAD CELL CAPACITY	A	B	C	D
Inches (mm)				
**500lb (226.8kg)	2.68 (68.1)	2.68 (68.1)	1/2-13 NC	9.50 (ref) (241.3)
**500lb (226.8kg)	2.68 (68.1)	2.68 (68.1)	5/8-11 NC	9.50 (ref) (241.3)
**500lb (226.8kg)	2.68 (68.1)	2.68 (68.1)	3/4-10 NC	9.50 (ref) (241.3)
750lb (340.2kg)	2.68 (68.1)	2.68 (68.1)	1/2-13 NC	9.50 (ref) (241.3)
750lb (340.2kg)	2.68 (68.1)	2.68 (68.1)	5/8-11 NC	9.50 (ref) (241.3)
750lb (340.2kg)	2.68 (68.1)	2.68 (68.1)	3/4-10 NC	9.50 (ref) (241.3)
1000lb (453.6kg)	2.68 (68.1)	2.68 (68.1)	1/2-13 NC	9.50 (ref) (241.3)
1000lb (453.6kg)	2.68 (68.1)	2.68 (68.1)	5/8-11 NC	9.50 (ref) (241.3)
1000lb (453.6kg)	2.68 (68.1)	2.68 (68.1)	3/4-10 NC	9.50 (ref) (241.3)
1500lb (680.4kg)	2.68 (68.1)	2.68 (68.1)	1/2-13 NC	9.50 (ref) (241.3)
1500lb (680.4kg)	2.68 (68.1)	2.68 (68.1)	5/8-11 NC	9.50 (ref) (241.3)
1500lb (680.4kg)	2.68 (68.1)	2.68 (68.1)	3/4-10 NC	9.50 (ref) (241.3)
2000lb (907.2kg)	2.68 (68.1)	2.68 (68.1)	1/2-13 NC	9.50 (ref) (241.3)
2000lb (907.2kg)	2.68 (68.1)	2.68 (68.1)	5/8-11 NC	9.50 (ref) (241.3)
2000lb (907.2kg)	2.68 (68.1)	2.68 (68.1)	3/4-10 NC	9.50 (ref) (241.3)
2500lb (1134.0kg)	2.68 (68.1)	2.68 (68.1)	5/8-11 NC	9.50 (ref) (241.3)
2500lb (1134.0kg)	2.68 (68.1)	2.68 (68.1)	3/4-10 NC	9.50 (ref) (241.3)
3000lb (1360.8kg)	3.37 (85.6)	3.37 (85.6)	3/4-10 NC	10.00 (ref) (254.0)
5000lb (2268.0kg)	3.37 (85.6)	3.37 (85.6)	3/4-10 NC	12.62 (ref) (320.5)

* Load Rating is per module

**Non-NTEP Celtron HTC-SS

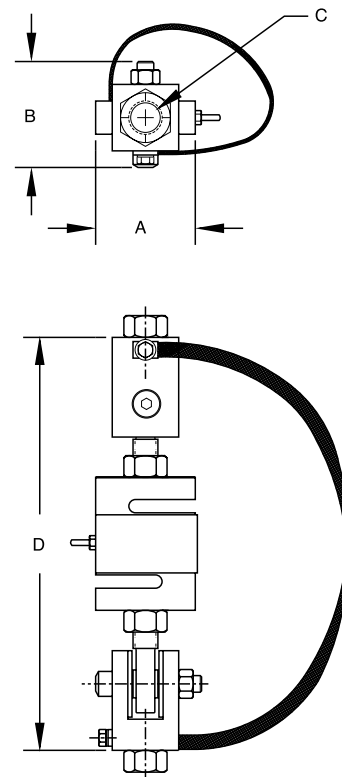

LOAD RATING (LOAD CELL CAPACITY)**

	Single Module	3-Module Kit	4-Module Kit
	PART #	PART #	PART #
*500lb (226.8kg).....	46599.....	46561.....	46580.....
*500lb (226.8kg).....	46600.....	46562.....	46581.....
*500lb (226.8kg).....	46601.....	46563.....	46582.....
750lb (340.2kg).....	46602.....	46564.....	46583.....
750lb (340.2kg).....	46603.....	46565.....	46584.....
750lb (340.2kg).....	46604.....	46566.....	46585.....
1000lb (453.6kg).....	46605.....	46567.....	46586.....
1000lb (453.6kg).....	46606.....	46568.....	46587.....
1000lb (453.6kg).....	46607.....	46569.....	46588.....
1500lb (680.4kg).....	46608.....	46570.....	46589.....
1500lb (680.4kg).....	46609.....	46571.....	46590.....
1500lb (680.4kg).....	46610.....	46572.....	46591.....
2000lb (907.2kg).....	46611.....	46573.....	46592.....
2000lb (907.2kg).....	46612.....	46574.....	46593.....
2000lb (907.2kg).....	46613.....	46575.....	46594.....
2500lb (1134.0kg).....	46614.....	46576.....	46595.....
2500lb (1134.0kg).....	46615.....	46577.....	46596.....
3000lb (1360.8kg).....	46616.....	46578.....	46597.....
5000lb (2268.0kg).....	46617.....	46579.....	46598.....

* Kit contains Celtron HTS SS 500lb load cell (cell is not NTI)

** Load rating is per module